

FARM LANDS. California Lands. Homeowner's Attention! Large tract of level rich valley farm land that will grow grains, garden truck, melons, etc. Plenty of water. Just opened up by the government. You can obtain 320 acres. Mild winters pleasant summers—fine stock country. Township maps, photographs and valuable information about this wonderful valley sent upon receipt of \$5. Spring Valley Land Co., 699 J. E. Bldg., Los Angeles, Cal., Dept. D.

YOU WANT A FARM IN CANADA AT 100, WITH 25 YEARS TO PAY. Take Your Map of Manitoba. Locate this elegant 240 acres, 2 1/2 miles west of Oak Bluff, 3 1/2 miles north of Sanford, 16 miles southwest of the city of Winnipeg, 250,000 population, 25 minutes ride onto the city. It has 120 acres fallow ready for crop in 1922, balance fine open prairie. No stone, no alkali, no scrub, deep black soil. Torrens title. \$1200 cash, then 25 yearly payments at 7 per cent. You never again will have such an opportunity to buy near a big city. Write to me.

H. E. STANLEY, ST. REGIS HOTEL, WINNIPEG, MANITOBA. FORWARD MARCH! A farm home of your own, for yourself, wife and kids. If you have a willing tractor and a little money this is what we can sell you on long time or drop payments. Best black soil in the world, tractor trails, little timber in spots. Lakes, creeks, game, fish, swimming, boat, tennis, golf, and all the pleasures of a big country. Write at once and you will see this at once. Scandinavian Land Co., 614 Phoenix Bldg., Minneapolis, Minn.

Colorado Lands. LAND BUYERS. Before you buy, attend the public auction sale of 10,560 Acres in Greeley County, Kansas. This is smooth, level, tractor land, and has the best soil and wheat land in America. The terms are: 25 per cent down the day of the sale, 25 per cent March 1, the balance on or before three or five years, interest at 6 per cent. It goes on sale, don't forget the date: Sept. 12th, 13th and 14th. Write us at once for further descriptions of tracts, maps and illustrations. This is a chance to buy already low priced land at a bargain. Write to THE NATIONAL LAND SALES CO., Burlington, Colo., or Tribune, Kan.

DON'T fail to investigate 2,900 acres wheat and corn land, Colorado. Soil, price and terms exceptional. Closing out corporation business. LeRoy Davis, Room 29, Opera House Block, Pueblo, Colo. FOR SALE or exchange, 1,200-acre improved ranch, 6 miles west of Arova, Lincoln county, Colo. One 8-room and one 10-room cement block dwellings, granary, chicken house, garage, horse stables and cattle shed, windmill and plenty water. See, Box A-102. THE WEST is calling you. But before you head that call send for a copy of the Western Real Estate Journal. It contains information and many fine illustrations. To receive a copy, name free, address 1725 Champ St., Denver, Colo.

Minnesota Lands. 80-ACRE farm, \$4,000, 2 1/2 miles from good town, city loan 800. House 16 x 26, barn 30x26, all fenced and cross-fenced. 35 acres wooded to clover and timothy. \$2,000 cash, balance 5 years at 6 per cent. Ask for free list of farms. Thorpe, Box 2, 2400 Andrew Bldg., Minneapolis, Minn. IMPROVED 1,200-ACRE RANCH. Near North Platte at sacrifice price. Must sell at once. Box 234, North Platte, Neb.

Nebraska Lands. FOR SALE BY OWNER—Viney improved quarter section near Cambridge, in Purchase county, 21 1/2 acres cultivated in corn field, 4-room house, big barn and silo; telephone and mail route; near school and church. This snap until September 1 at \$75 an acre, easy terms. Thos. J. Minnick, Cambridge, Neb. NEBRASKA LANDS. WE SPECIALIZE IN DUNDÉE HOMES. C. B. STUHT CO., City Nat'l Bldg., Douglas 5787.

NEBRASKA LANDS. WE SPECIALIZE IN DUNDÉE HOMES. C. B. STUHT CO., City Nat'l Bldg., Douglas 5787.

NEBRASKA LANDS. WE SPECIALIZE IN DUNDÉE HOMES. C. B. STUHT CO., City Nat'l Bldg., Douglas 5787.

NEBRASKA LANDS. WE SPECIALIZE IN DUNDÉE HOMES. C. B. STUHT CO., City Nat'l Bldg., Douglas 5787.

NEBRASKA LANDS. WE SPECIALIZE IN DUNDÉE HOMES. C. B. STUHT CO., City Nat'l Bldg., Douglas 5787.

NEBRASKA LANDS. WE SPECIALIZE IN DUNDÉE HOMES. C. B. STUHT CO., City Nat'l Bldg., Douglas 5787.

NEBRASKA LANDS. WE SPECIALIZE IN DUNDÉE HOMES. C. B. STUHT CO., City Nat'l Bldg., Douglas 5787.

NEBRASKA LANDS. WE SPECIALIZE IN DUNDÉE HOMES. C. B. STUHT CO., City Nat'l Bldg., Douglas 5787.

NEBRASKA LANDS. WE SPECIALIZE IN DUNDÉE HOMES. C. B. STUHT CO., City Nat'l Bldg., Douglas 5787.

NEBRASKA LANDS. WE SPECIALIZE IN DUNDÉE HOMES. C. B. STUHT CO., City Nat'l Bldg., Douglas 5787.

NEBRASKA LANDS. WE SPECIALIZE IN DUNDÉE HOMES. C. B. STUHT CO., City Nat'l Bldg., Douglas 5787.

REAL ESTATE WANTED. THE Old Reliable Real Estate Office, M'CAIG INVESTMENT CO., 1208 Dodge St., Douglas 1218. PROMPT sale of your real estate; we have many buyers and solicit your business. Shopen & Co., Realtors, J.A. 4225. HAVE inquiries for homes—do you want to sell your property? Let us with C. A. Grimmel, Omaha Nat'l Bldg. BIRKETT REAL ESTATE REALTORS, 240 Peters Trust Bldg., Jackson 6531. LIST homes and income property with GRUENIG REALTY CO., 1418 1st Nat. Bldg., Jackson 1964. WANT to buy 5 or 6-room house, west of southwest, \$1,000 cash. Address Box K-7, Omaha Bee. TO BUY OR SELL real estate see Glover & Spear, 318-20 City National Bank, Jackson 2150. VACANT lot on 47th and Cumine St., Omaha, Neb. Price \$600. Owner, T. B. Siphers, South Colby, Washington. LIST with us. We guarantee results. STIER REALTY CO., 715 Bee DO. 4545. REAL ESTATE—UNIMPROVED. Vacant Lots. 50x124, south front lot on Locust, head of 21st street; \$1,000. 50x124, south front lot on Lothrop, near 21st; \$1,000. Two lots, 50x124, on 21st street, north of Kountze street at \$600 each. 50x124, south front on Dewey avenue, near 42d street for \$1,000. Three lots each 45x127 at \$200 each located on Decatur street near 34th. W. H. Gates, 647 Om. Nat. Bk. Bldg., Jackson 1284.

REAL ESTATE INVESTMENTS. Both Investment and Speculation. A dandy, good double house on S. 24th St., where values are rapidly increasing; 3 rooms and bath on first floor, lot and garage. Everything in excellent shape. Price \$7,000, on easy terms. Call me for more particulars. Investment and has good speculative value. Bedford-Johnston Co., Realtors, 806 World-Herald Bldg., Jackson 1724. Home Plus Investment. Near 31st and Leavenworth Sts., 6-room bungalow type. Large rooms, oak finish, furnace heat. Lot 50x134 ft. Price upon application. George & Company, Atlantic 3024.

REAL ESTATE TO EXCHANGE. Wanted—Real Estate in Omaha. For Iowa, Nebraska and Colorado lands. Have a number of good exchanges for income and residence property in Omaha. What have you? Box R-61, Omaha Bee. 150-acre Iowa farm, clear, will trade for Omaha income property and will pay difference. Write owner, Frank L. Kirby, 440 Peters Trust Bldg., Omaha. HAVE section Nebraska land to deal for Omaha income—clear for clear. Look Box 443, Sioux City, Ia. FOR SALE or trade, 320 acres deeded oil land in leased in proven district. Box 145, Miles Hy. Mont. REAL ESTATE—SUBURBAN. Dundee. New Bungalow Home. Price Reduced \$15,000. An exceptionally well constructed home of stucco with brick foundation and porch with cement floor. Has tile vestibule with cloak room. Large living room, fireplace, sun room, dining room, breakfast room, butler's pantry, kitchen, refrigerator room, finished in white enamel, oak floors throughout. Third floor has two study rooms and bath and large linen closet. Full equipped basement, coal bin, fruit and water pump system. Roud heater; house equipped with vacuum cleaning system. The owner is leaving the city and will sell part of the furnishings with this home. For full detail call. George & Company, Atlantic 3024.

Am Forced to Sell 10 Lots at a Bargain. I must quit my 50x124 feet with 14-foot alley. Large shade tree on each lot; only 3 blocks south from 21st street, on 42d, from Bond to Grant Street. CALL DOUGLAS 5287.

Dundee Edgewood Lot. We have only about six more bungalow lots left in Edgewood out of 40 lots. Call E. N. Benson, Walnut 4008; week days, Douglas 5974.

The Byron Reed Company. Dundee District. Brick home, located on south front lot 50x137 feet; living room 15x24 feet, dining room 13x17 feet, sun room 12x12 feet and convenient kitchen, first floor; four large bedrooms and tile bath second floor; finished in white enamel, oak floors throughout; Arco hot water heater system; Roud heater; house equipped with vacuum cleaning system. The owner is leaving the city and will sell part of the furnishings with this home. For full detail call. George & Company, Atlantic 3024.

Vacant. South front lot on Leavenworth Street, near entrance to Elmwood Park, 50x124. A beautiful site for a home. \$1,150. No. 21st, Atlantic 2219. Sun room and evening. Week days, Douglas 5074.

Cathedral District Lot. Near Sacred Heart, corner 21st and 21st street, lot 42x124, paving paid; \$750 cash, balance \$10 a month and interest. O'Keefe Real Estate Co., REALTORS, 1016 Omaha Nat. Bank Bldg., Jack. 3718. CLAIRMONT LOT. East front of Fontainebleau Blvd. Owner will sacrifice for quick sale. Call Atlantic 2540.

5-Acre Tracts in City. I have two 5-acre tracts on West Center that I will sell at a bargain and on good terms. Both are improved; buildings, 100x100 ft. lots, etc. Here is a real investment for anyone who acts quickly. Lad V. Tesar, 14th and William, Douglas 8287.

REAL ESTATE INVESTMENTS. WE CAN SAFELY RECOMMEND THESE INVESTMENT PROPERTIES AND YOU CAN SAFELY BUY. \$11,000, Brick Flats. A good 2-apartment brick flat and frame house; handy to high school and downtown; good, clean property; low rental at \$115 per month. \$16,000, Store Building. This is first-class property in excellent condition; very large corner lot; should retail at \$18,000. Asking \$16,000. Cash or 10 per cent; must be cash; no trade. Want An Offer. We are offering a large corner lot on Sherman Ave. and four very good houses that should retail at \$18,000. Asking \$14,500, but can do better. Want a cash offer. Rental value, \$135 per month. Brick Business Block. Strictly business block. One-story brick building, large corner, taking care of all community requirements; on car line near Hanson; excellent investment. Price reduced for quick sale. GLOVER & SPAIN, REALTORS, Jackson 2850, 315-20 City National.

19th and Capitol Avenue. 60x120, on corner with three houses, annual income \$1,410. On account of Dodge street being graded and its attendant high-level improvements including \$1,500,000 new club at 18th and Dodge, lots will rapidly develop into close-in downtown property. 24th Street Corner. 60x152, having 234 ft. frontage on 3 streets, this will prove a good investment. Located 24th street in widened. Investors are predicting 24th street to become our 16th street of the future. O'Keefe Real Estate Co., REALTORS, 1016 Omaha Nat. Bank Bldg., Jack. 3718. E. H. BENNER CO. TRUCKAGE.

“Wildcat” Losses Will Divert Money to Real Estate, Realtor Says. Recent exposures of heavy losses and gross irregularities in the management of “wildcat” stock selling schemes will have a tendency to divert Nebraska investment money into real estate hereafter, in the opinion of George F. Jones. “I have talked with financial men from all parts of the state in the last two weeks,” Mr. Jones told the Real Estate board last week. “Their opinion is without exception that the present generation, at least in Nebraska, will never spend another dollar buying stock in promotion schemes. “The reason for this is very obvious. Everybody in Nebraska knows without question that promotion schemes are dangerous and liable to failure. The leases have been so heavy that nobody is going to take a chance again on any kind of investment that is not absolutely safe. “Investors, of course, all know that real estate is one commodity which can't be stolen and which won't go broke.”

REAL ESTATE INVESTMENTS. WE CAN SAFELY RECOMMEND THESE INVESTMENT PROPERTIES AND YOU CAN SAFELY BUY. \$11,000, Brick Flats. A good 2-apartment brick flat and frame house; handy to high school and downtown; good, clean property; low rental at \$115 per month. \$16,000, Store Building. This is first-class property in excellent condition; very large corner lot; should retail at \$18,000. Asking \$16,000. Cash or 10 per cent; must be cash; no trade. Want An Offer. We are offering a large corner lot on Sherman Ave. and four very good houses that should retail at \$18,000. Asking \$14,500, but can do better. Want a cash offer. Rental value, \$135 per month. Brick Business Block. Strictly business block. One-story brick building, large corner, taking care of all community requirements; on car line near Hanson; excellent investment. Price reduced for quick sale. GLOVER & SPAIN, REALTORS, Jackson 2850, 315-20 City National.

19th and Capitol Avenue. 60x120, on corner with three houses, annual income \$1,410. On account of Dodge street being graded and its attendant high-level improvements including \$1,500,000 new club at 18th and Dodge, lots will rapidly develop into close-in downtown property. 24th Street Corner. 60x152, having 234 ft. frontage on 3 streets, this will prove a good investment. Located 24th street in widened. Investors are predicting 24th street to become our 16th street of the future. O'Keefe Real Estate Co., REALTORS, 1016 Omaha Nat. Bank Bldg., Jack. 3718. E. H. BENNER CO. TRUCKAGE.

REAL ESTATE INVESTMENTS. WE CAN SAFELY RECOMMEND THESE INVESTMENT PROPERTIES AND YOU CAN SAFELY BUY. \$11,000, Brick Flats. A good 2-apartment brick flat and frame house; handy to high school and downtown; good, clean property; low rental at \$115 per month. \$16,000, Store Building. This is first-class property in excellent condition; very large corner lot; should retail at \$18,000. Asking \$16,000. Cash or 10 per cent; must be cash; no trade. Want An Offer. We are offering a large corner lot on Sherman Ave. and four very good houses that should retail at \$18,000. Asking \$14,500, but can do better. Want a cash offer. Rental value, \$135 per month. Brick Business Block. Strictly business block. One-story brick building, large corner, taking care of all community requirements; on car line near Hanson; excellent investment. Price reduced for quick sale. GLOVER & SPAIN, REALTORS, Jackson 2850, 315-20 City National.

19th and Capitol Avenue. 60x120, on corner with three houses, annual income \$1,410. On account of Dodge street being graded and its attendant high-level improvements including \$1,500,000 new club at 18th and Dodge, lots will rapidly develop into close-in downtown property. 24th Street Corner. 60x152, having 234 ft. frontage on 3 streets, this will prove a good investment. Located 24th street in widened. Investors are predicting 24th street to become our 16th street of the future. O'Keefe Real Estate Co., REALTORS, 1016 Omaha Nat. Bank Bldg., Jack. 3718. E. H. BENNER CO. TRUCKAGE.

19th and Capitol Avenue. 60x120, on corner with three houses, annual income \$1,410. On account of Dodge street being graded and its attendant high-level improvements including \$1,500,000 new club at 18th and Dodge, lots will rapidly develop into close-in downtown property. 24th Street Corner. 60x152, having 234 ft. frontage on 3 streets, this will prove a good investment. Located 24th street in widened. Investors are predicting 24th street to become our 16th street of the future. O'Keefe Real Estate Co., REALTORS, 1016 Omaha Nat. Bank Bldg., Jack. 3718. E. H. BENNER CO. TRUCKAGE.

19th and Capitol Avenue. 60x120, on corner with three houses, annual income \$1,410. On account of Dodge street being graded and its attendant high-level improvements including \$1,500,000 new club at 18th and Dodge, lots will rapidly develop into close-in downtown property. 24th Street Corner. 60x152, having 234 ft. frontage on 3 streets, this will prove a good investment. Located 24th street in widened. Investors are predicting 24th street to become our 16th street of the future. O'Keefe Real Estate Co., REALTORS, 1016 Omaha Nat. Bank Bldg., Jack. 3718. E. H. BENNER CO. TRUCKAGE.

19th and Capitol Avenue. 60x120, on corner with three houses, annual income \$1,410. On account of Dodge street being graded and its attendant high-level improvements including \$1,500,000 new club at 18th and Dodge, lots will rapidly develop into close-in downtown property. 24th Street Corner. 60x152, having 234 ft. frontage on 3 streets, this will prove a good investment. Located 24th street in widened. Investors are predicting 24th street to become our 16th street of the future. O'Keefe Real Estate Co., REALTORS, 1016 Omaha Nat. Bank Bldg., Jack. 3718. E. H. BENNER CO. TRUCKAGE.

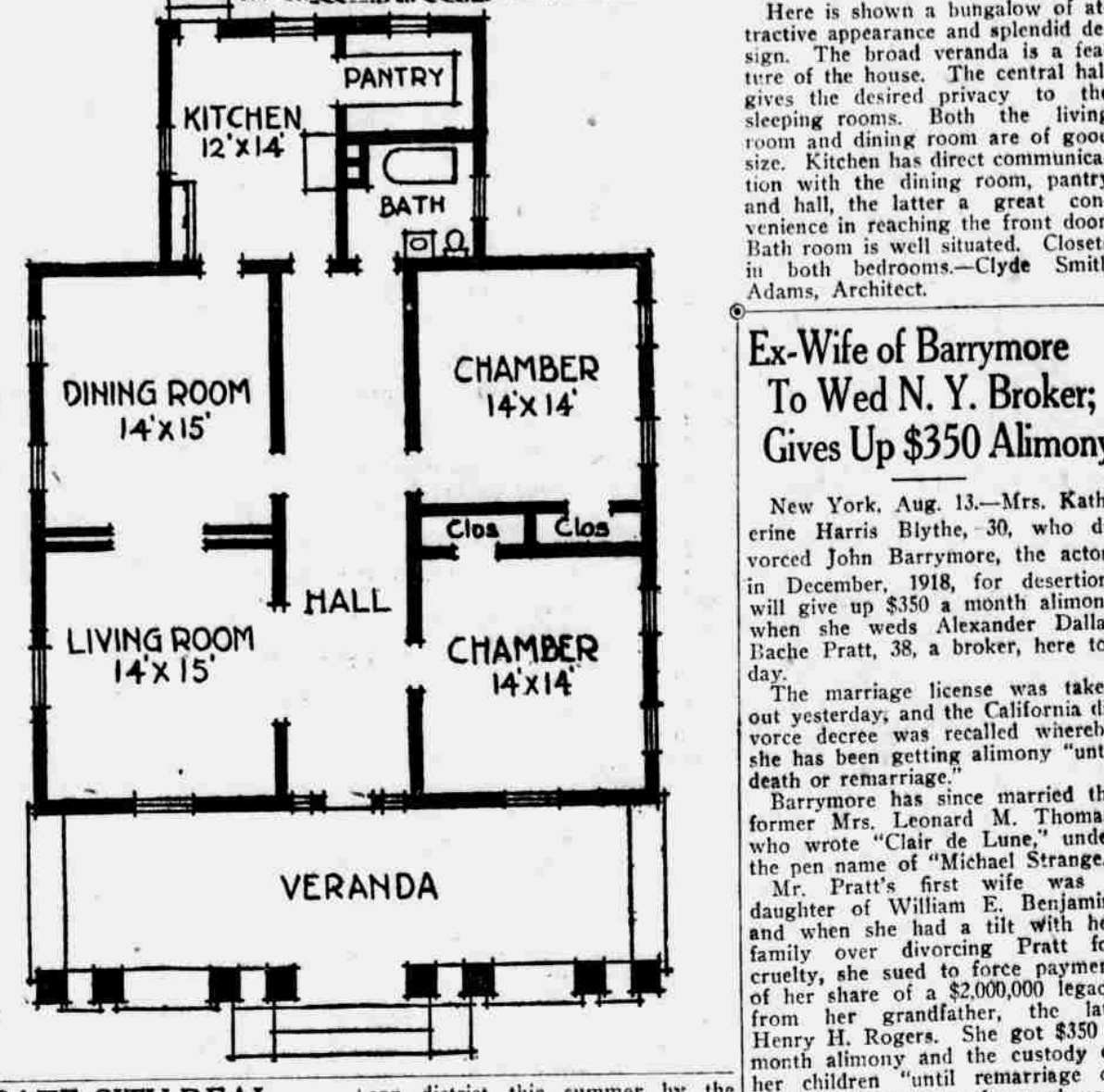

Here is shown a bungalow of attractive appearance and splendid design. The broad veranda is a feature of the house. The central hall gives the desired privacy to the sleeping rooms. Both the living room and dining room are of good size. Kitchen has direct communication with the dining room, pantry and hall, the latter a great convenience in reaching the front door. Bath room is well situated. Closets in both bedrooms.—Clyde Smith Adams, Architect.

Ex-Wife of Barrymore To Wed N. Y. Broker; Gives Up \$350 Alimony. New York, Aug. 13.—Mrs. Katherine Harris Blythe, 30, who divorced John Barrymore, the actor, in December, 1918, for desertion, will give up \$350 a month alimony when she wed Alexander Dallas Baehle Pratt, 38, a broker, here today. The marriage license was taken out yesterday, and the California divorce decree was recalled whereby she has been getting alimony “until death or remarriage.” Barrymore has since married the former Mrs. Leonard M. Thomas, who wrote “Clair de Lune,” under the pen name of “Michael Strange.” Mr. Pratt's first wife was daughter of William E. Benjamin, and when she died he divorced her. She sued for force payment of her share of a \$2,000,000 legacy from her grandfather, the late Henry H. Rogers. She got \$350 a month alimony and the custody of her children “until remarriage or death,” and not long afterward married Preston Gibson, playwright and society man.

New Rules to Raise Standard of U. S. Army. Washington, Aug. 13.—By direction of the secretary of war new requirements to govern enlistment in the regular army are soon to be issued. The new regulations will be more strict than any heretofore promulgated and are designed to raise the standard of enlisted personnel, now that the size of the army must be reduced. “I would rather have an army of 100,000 good men,” said Secretary Weeks, “than an army of 200,000 indifferent men.” The new regulations will raise the standard materially. Figures on reduction of the army, available at the headquarters today, indicated that the regular army already has been reduced to approximately 155,000 men.

Son of Tobacco King Held In Auto Accident. New York, Aug. 13.—Angier B. Duke, founder of the American Tobacco company, was under \$2,000 bond for three days as a result of his connection with a fatal automobile accident before that fact became generally known. Duke's hearing with that of other defendants was continued yesterday because Magistrate Coburn was not satisfied with the evidence, which he said, was contradictory. Duke's car scraped a truck and forced it aside. The truck crushed Owen Kivlon, a pedestrian, to death.

Stuht Company Announces Sales Totalling \$43,950. Sales of real estate totalling \$43,950 are announced by the C. B. Stuht company, for last week. They include three Dundee homes, two duplex houses, four lots, and a piece of Sherman avenue property. The Stuht company has started a two-story brick veneer house at 107 South Fifty-first avenue for James S. Willebrand, who recently came here from Buffalo, N. Y.

Former Premier Maura Heads New Spanish Cabinet. Madrid, Aug. 13.—Former Premier Maura today assumed the premiership of the new Spanish cabinet, which replaces that of Premier Alendalazalar, who resigned on Thursday. Premier Maura appointed Don Manuel Gonzalez Hontoria minister of foreign affairs and Senor La Cierva minister of war.

London Editor Sees U. S. Re-Entry in Allies' Councils. Portland, Ore., Aug. 13.—The return of the United States to cooperation with the other powers in straightening out the tangles created by the great war and what has followed it, is foreseen in the conference called at invitation of President Harding and is looked upon with delight by the powers of Europe, according to H. Herickham Steed, editor of the London (England) Times, who arrived in Portland yesterday and was to leave last night for San Francisco. Mr. Steed is returning from Victoria, B. C., whence he accompanied Lord Northcliffe, now on his way to Australia.

Building Five Houses. Hastings & Heyden has started a new \$10,000 house, with garage in connection, at the northeast corner at Thirty-fifth and Pine streets. This makes five houses this firm has under construction.

Realtor on Vacation. A. H. Walsh, head of Walsh-Elmer company, accompanied by Mrs. Walsh, has gone to Lake Okoboji and the Minnesota lakes for a vacation.

Six Houses Sold. The six new houses built in Ben-

Hope for Passage Of Rail Act Before Vacation Gone

La Follette Blocks Action by Insisting Upon Inquiry as to How Roads Spend Funds.

Washington, Aug. 13.—Any remaining possibility of the passage of the administration railroad funding bill before congress recesses went glimmering yesterday, when Senator La Follette of Wisconsin blocked action in the senate committee on interstate commerce.

After Senator La Follette had insisted upon an inquiry relative to the manner in which the railroads have expended their funds and then objected to any action without a quorum present, the committee adjourned until next Tuesday.

Administration senators said that the bill probably would be reported from the committee next week, despite Senator La Follette's objections, but that it would not be pressed on the floor of the senate until after the recess. Senator Townsend of Michigan, who introduced the bill in the senate, was in conference with President Harding during the day and is understood to have told the president the bill could not be passed at this session, which the president regrets.

Senator La Follette urged that the senate committee summon William G. McAdoo, former director general of railroads, as a witness. He said that he had communicated with Mr. McAdoo over the long distance telephone and that the latter is willing to appear before the committee if requested to do so.

The Wisconsin senator said he also had cabled Walker D. Hines, former director general of railroads, who is in Europe, inquiring at what date it might be possible for him to appear.

Besides getting the testimony of the two former directors general, Senator La Follette insisted that evidence should be obtained relative to the manner in which they have operated their properties since the roads were returned to private control.

“I venture to say that some railroads, at the very time they have claimed to be hard pressed for money,” said increasing salaries,” said senator La Follette. “If we go into this matter we will find that the New York Central was raising the salaries of President Smith from \$75,000 to \$100,000 and of other officials by additional amounts ranging from \$5,000 to \$20,000.

“I think it is a pertinent matter to show that the roads have squandered their money instead of concentrating them and that they are now trying to get the government to relieve them from financial distress.”

Twenty Persons Injured In Wreck Near Pueblo. Pueblo, Aug. 13.—Twenty persons were injured, three of them seriously, enough to be taken to a hospital, when passenger train No. 11, east bound, on the Atchison, Topeka & Santa Fe railway was wrecked at Devine, 10 miles east of Pueblo.

The seriously injured were: Mrs. Alice Dunkin of Kerwin, Kan., who suffered severe cuts about the head and arms, George Williams, a negro, Denver, and H. F. Patrick, Coffeyville, Kan., dislocated shoulder.

The cause of the accident was the breaking of the axle on one of the main drive wheels of the locomotive. This spread the rails and permitted the wheels on the coaches following to leave the track and two baggage cars, the smoker, two chair cars and two Pullmans went off the rails. Three Pullmans stayed on the rails.

Export Demand and Crop Report Boost Wheat Price. Chicago, Aug. 13.—Active export demand together with correct anticipations that the government crop report would prove to be a good deal this week to lift the value of wheat. Compared with a week ago wheat prices this morning showed gains of 1/8c to 1/4c a bushel, corn was 1/4c to 1/2c and soybean advance, oats of 1/8c to 1/4c and rye 1/8c to 1/4c.

Report business in wheat appeared to have been helped by a sharp advance in sterling exchange and by word that Germany had obtained large credits in New York. Efforts for world-wide relief of Russian famine were also regarded as a stimulus for foreign buying. On the other hand, heavy profit-taking sales after the United States government crop report was fully discounted beforehand the big reduction in estimates of yield as compared with previous years. Renewed demand from exporters and from domestic millers rallied the market again but confidence on the part of bulls was afterward somewhat disturbed by the fact that wheat production in France this season was much greater than the trade here had been led to believe.

RAINBOW OVERALLS. World of wear in every pair. Union Made. Sold exclusively at PHILIP'S DEPT. STORE 24th and O Streets.

THE OMAHA BEE furnishes a complete and prompt

Base Ball Score Board. for the benefit and convenience of SOUTH SIDE residents on the windows of PHILIP'S DEPARTMENT STORE 24th and O Streets The Omaha Bee

Government Auction

800 buildings, with boilers low and high pressure radiation, plumbing fixtures, machinery, etc.; laundry machinery, electric motors, refrigerators, furnaces complete, 24-ton ice plant, coffee roasting plant, bakery, harness, nose bags, saddles, stoves, ranges, kitchen tables, dining room chairs, clothing, rubber boots, shoes, overcoats, undershirts, service hats, khaki breeches, beds, cots, pillows, mattresses, comforts, bed sacks, office supplies, office furniture, field desks, water coolers, scales, fire extinguishers, etc.

AUGUST 16, 17, 18, 19 10 A. M. SHARP

H. L. ROGERS Quartermaster General of the Army Gerths Realty Experts of New York and New Orleans, Auctioneers

Building, 801 Camp Funston, Kansas

Gerth's Realty Experts

SPECIAL USED TRUCK SALE

- All trucks listed below are in first class condition. All are bargains. 1 Reo Speedwagon Chassis \$900.00 1 Reo Speedwagon, express body and canopy top \$1,250.00 1-1 Ton Bethlehem, open express body and cab \$800.00 1-1 Ton Republic chassis, pneumatic tires, like new \$850.00 1-1 Ton Nash, farm body and cab \$900.00 1-2 Ton Stewart, enclosed cab and stake body; this truck is nearly new \$2,400.00 1-1 Ton Ford Chassis and cab \$450.00 1-1/2 Ton delivery truck \$500.00 1 Dodge delivery truck, screen sides, nearly new \$750.00 1 Dodge delivery truck \$450.00 1-1 Ton Republic express body and cab \$850.00 1-1 Ton Ford with new Dearborne attachment; new body and cab \$650.00 1 Ford delivery truck \$400.00 1-1 Ton Ford truck with farm body and cab, nearly new \$950.00 Other Good Bargains Terms to Responsible Parties

Jones Oppor Company Phone Harney 0635 2566 Farnam St.