

Daily Nebraskan

March 8, 1991

University of Nebraska-Lincoln

Vol. 90 No. 116



WEATHER

Partly sunny today with the high in the upper 40s and becoming windy later. Tonight, partly cloudy with the low 20-25. Saturday, warmer with the high in the lower 50s.

Party to charge misconduct

By Dionne Searcey
Staff Reporter

The HORIZN party plans today to accuse J. Matt Wickless, ENERGY presidential candidate, of misdeeds during his term in the Residence Hall Association senate two years ago, HORIZN senatorial candidate Colin Theis said.



The party will make the accusations against Wickless to "inform" students voting for leaders of the Association of Students of the University of Nebraska about the candidates, Theis said. The election is Wednesday.

HORIZN plans to state that Wickless was accused of "lying to RHA senate about his grade status" so he could be elected as RHA speaker in 1989, Theis said.

A grade point average of 2.0 is required to hold RHA positions.

John Gibson, campaign manager for ENERGY, said the allegation was

"unacceptable."

A statement issued by the ENERGY party Thursday said Wickless was above the required GPA until he returned from semester break and informed the RHA adviser that his GPA was below the requirements. When Wickless' grade deficiency was corrected, he was elected RHA president.

Theis said HORIZN also planned to state that Wickless used RHA funds "to take out to dinner certain members of his RHA senate committee which he chaired."

Gibson said \$13.05 in RHA funds was used at Burger King when Wickless took members of the review recommendation board to dinner. Those funds were approved by the RHA treasurer and president at that time, he said.

"There was no scandal involved," he said.

The ENERGY party said that none of the HORIZN candidates were members of RHA when Wickless served in the organization.

"This information would be therefore no better than second-hand at best," ENERGY's statement said.

ENERGY said that if HORIZN members wanted their opinions to be objective, they would have contacted Wickless for comment.

The HORIZN party plans to endorse the UNITY party's executive candidates today. HORIZN has no executive candidates on its slate.

"If the UNITY party, who claims to be attempting to run a clean campaign, wishes to maintain their own integrity, the ENERGY party then challenges them to refuse the endorsement of HORIZN," ENERGY said.

Eric Thurber, first vice presidential candidate for UNITY, said the UNITY party is not involved in making allegations.

"We're not a part of it. We're not mudslinging . . . We'll keep our promise not to mudsling," he said.

Gibson said his party, ENERGY, has run a clean campaign thus far. He said ENERGY had heard rumors about members of other parties but chose not to publicize them.

But Theis said the accusations are not mudslinging.

HORIZN has scheduled a press conference for today at 3 p.m. in Room 216 of the Nebraska Union.

Senators reword bylaws to erase minority quotas

By Adeana Leftin
Staff Reporter

Following ASUN's refusal Wednesday to pass racial affairs and sexual orientation subcommittees, some ASUN senators Thursday said they have devised another plan.

The question of whether the proposal is constitutional, however, still looms.

Several senators met Wednesday after the Association of Students of the University of Nebraska meeting to compose amendments to establish a Racial Affairs Committee and a Gay/Lesbian/Bisexual Affairs Committee.

Business Sen. Shawn Smith, who co-authored the bylaw amendments, said the proposal essentially would remove the quotas outlined in previous legislation that the Student Court ruled unconstitutional.

Last semester, ASUN set up two standing committees for racial af-

fairs and gay/lesbian/bisexual affairs. Included in the bylaws were quotas requiring some committee members to be selected on the basis of race or sexual orientation.

The Student Court ruled last week that the committees violated ASUN bylaws.

Senators reworded the proposed gay/lesbian/bisexual bylaws to read: "The senate strongly encourages that the following sexual orientation perspectives are represented on this committee: bisexual, gay, heterosexual and lesbian."

The proposed racial affairs bylaws were reworded to read:

"The senate strongly encourages that the following racial perspectives are represented on the committee: African American, Asian-American, Caucasian-American, Latino-American and Native American."

College of Arts and Sciences

See ASUN on 3

FRIDAY

The process of bringing Kearney State College into the NU system moves toward July 1 deadline. **Page 2.**

Husker guard finds an attitude adjustment improved his game. **Page 7.**

Blues and the harmonica are this musician's style. **Page 9.**

INSIDE

Wire	2
Opinion	4
Sports	7
A&E	9
Classifieds	11

Law instructor waits for petition response

By Lisa Donovan
Senior Reporter

A UNL law instructor said she will wait to see how the College of Law responds to a petition that calls for a fair tenure and promotion review of her before moving ahead with her allegations of discrimination against the college.

The petition was circulated by students after Emily Fowler Hartigan, an assistant professor in the law college, said she had been unjustly denied tenure in May and September 1990, then denied a promotion to associate professor in February.

Hartigan said she thinks she is being discriminated against because her counterpart, a male colleague at the law college, had received tenure even though he had less education and had been published less than Hartigan.

Hartigan also contended she is being discriminated against because she conducts research within feminist jurisprudence and uses feminist teaching methods.

"It's discrimination, or at least what I perceive to be discrimination," she said.

Harvey Perlman, dean of the law college, said that the law faculty would not make a personal discriminatory judgement.

"The faculty would not make a personnel

judgement . . . on the basis of a person's . . . gender," Perlman said.

Perlman said he did not wish to further comment on matters of personnel.

Hartigan, who has been an assistant professor at the UNL law college for four years, received her law degree at the University of Wisconsin in 1978. She practiced law for eight years before coming to UNL.

Hartigan said she is keeping her options open but has planned to either file a lawsuit against the university or find a teaching job elsewhere.

See TENURE on 6



William Lauer/Daily Nebraskan

Joni Thomas says her dog, 3 1/2-year-old Purina, assists her in everyday activities like pushing elevator buttons and carrying things. Thomas says Purina knows 80 commands.

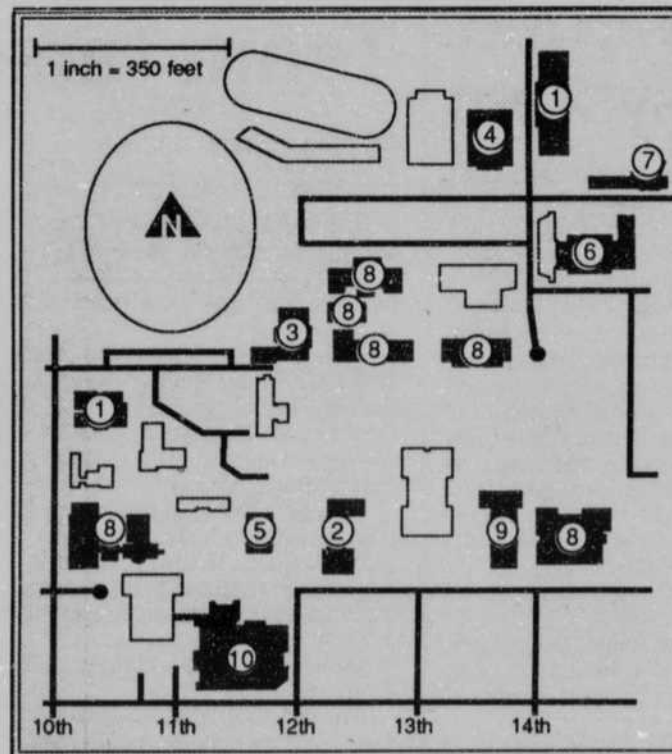

Accessibility on Campus

- ① Richards and Mabel Lee halls -- not accessible
- ② CBA -- accessible only on first floor
- ③ Avery Hall -- difficult to enter; once inside OK
- ④ Military and Naval Science -- must enter through freight doors in back
- ⑤ Sheldon -- must enter through back
- ⑥ Bancroft -- only accessible in parts of the basement
- ⑦ Henzlik -- only accessible on first floor and part of basement
- ⑧ Bessey, Oldfather, Burnett, Andrews and Architecture halls, and Nebraska Union -- all accessible
- ⑨ Administration -- south end accessible; only basement and first floor of north end is accessible
- ⑩ Lied Center for Performing Arts -- accessible but must enter through Johnny Carson Theater

Source: UNL Handicapped Student Services

Amie DeFrain/Daily Nebraskan

Student cites faults in accessibility

By Shelley Miller
Staff Reporter

For most students, getting to class is the easy part — so easy it can be taken for granted.

Joni Thomas does not take it for granted.

As a post-polio paraplegic and a graduate student at the University of Nebraska-Lincoln, accessibility issues are important to Thomas.

To her, an out-of-order elevator or a door with a latch could mean not making it to class.

Thomas said problem areas on campus remain because some administrators have the attitude that UNL has better accessibility than many schools, so students should be happy.

"I don't take that view, I never have, I don't think it is a healthy one," she said.

Thomas said she has had difficulty with one class in particular this semester.

The class originally was scheduled for Bancroft Hall, but because that building is not accessible to handicapped students, the class was

moved to Walter Scott Engineering Center.

The only elevator in Walter Scott is a freight elevator with a gate, so Thomas must wait until someone comes by to help her open it.

"I don't think anyone in a chair, even someone with a strong upper body, could open that gate," she said.

At night, all the doors in the building are locked except for one that opens into a stairway, so she

See DISABLED on 6