

REAL ESTATE—NORTH SIDE

REAL ESTATE—NORTH SIDE

REAL ESTATE—NORTH SIDE

REAL ESTATE—NORTH SIDE

REAL ESTATE—NORTH SIDE

REAL ESTATE—NORTH SIDE

Minne Lusa Now on Sale

Fine Lots Low Prices Easy Terms Building Restrictions

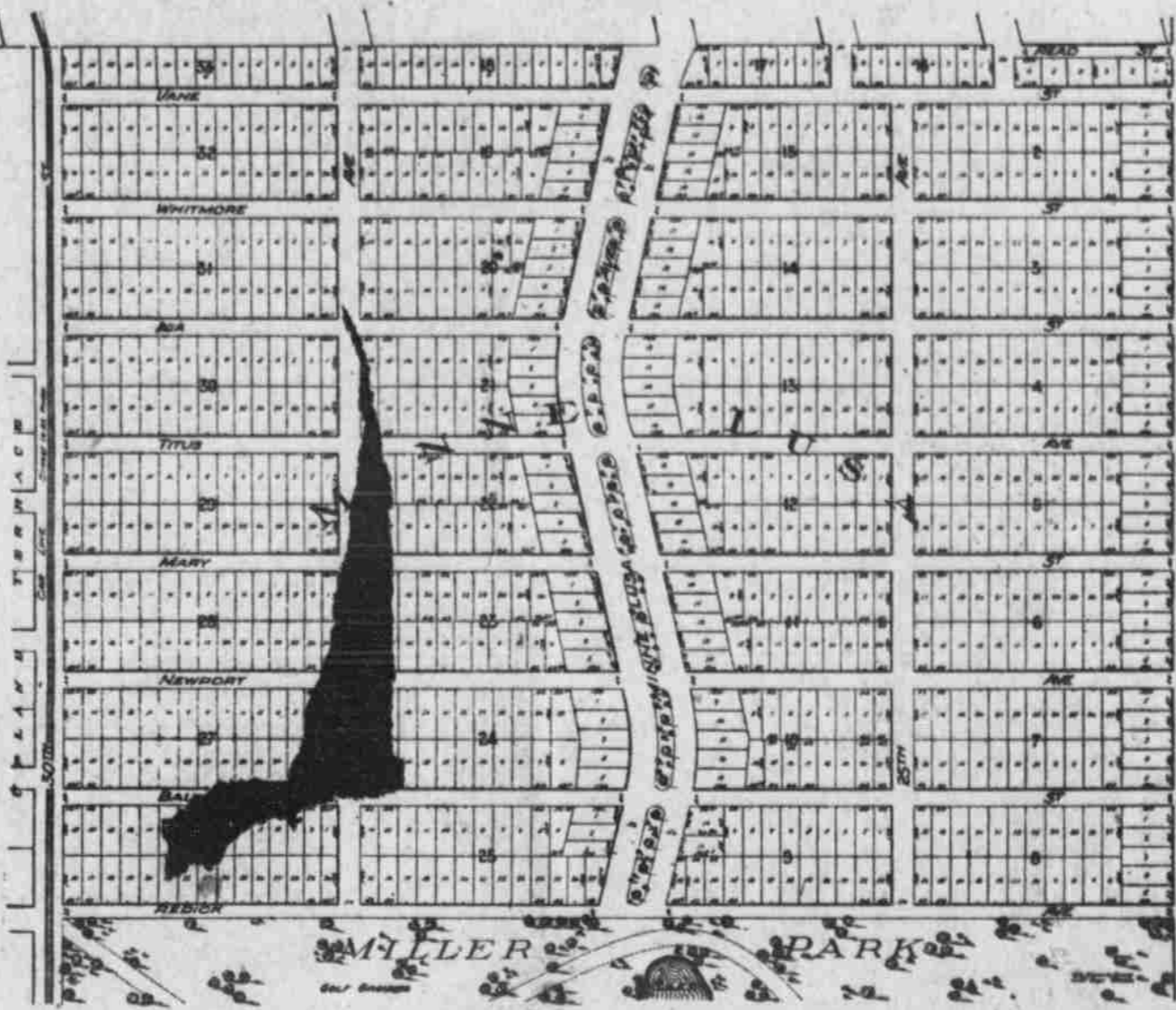

\$400 \$500 \$600 \$700 \$750 \$900 \$1,000

Prices INCLUDE SEWER MAINS, WATER MAINS, SIDEWALKS AND GRADING. Small payment down—Balance \$10 to \$15 per month.

This beautiful tract of 800 lots—the largest addition ever platted in Omaha, now offered for the first time. The hum of industry is out there.

The City Engineer has established grades for all streets and we have brought the lots and streets to perfect grade. Muentefering has surveyed and staked each lot and the Plat of MINNE LUSA has been accepted and is recorded.

The County and City Treasurer has certified that all taxes are paid. The Reed Abstract Company has made the abstracts of Title for each Lot. Benedict is putting in 12 miles of sidewalk. The Street Car Company are putting in new rails on 30th street. The Gas Company have finished a 2,000-foot main in 24th street and are putting in a still longer one in 30th street, in order that they can serve properly this great sub-division.

The Metropolitan Water District are putting in a large main a mile in length on 30th street, making the FOURTH main for this district. Hugh Murphy has the Contract for PAVING 24th street, and 30TH STREET is to be paved from Fort street to Florence AT ONCE.

The great storm sewer is being built through Miller Park.

Fifteen HOMES ALREADY STARTED and a HUNDRED MORE to start at once, these are FACTS, not "Promises."

Minne Lusa

has no competition in the Real Estate markets of Omaha.

CHARLES W. MARTIN & COMPANY,

Tyler 187

Look at all the other lots offered, compare our PRICES and IMPROVEMENTS, with ANY PRICES AND IMPROVEMENTS, and you must admit that we are offering to you the ONE BEST OPPORTUNITY to MAKE MONEY.

Location

MINNE LUSA lies along the north side of MILLER PARK, and between two great arteries of travel, 24th and 30th, 8 blocks square.

Come Out Saturday or Sunday Salesmen on the ground

This will be the greatest sale ever made here and the early buyers will get the profit.

742 Omaha National Bank Building

FOR RENT

Houses and Cottages. Miscellaneous.

Globe Van & Storage
Stores, moves, packs, ships; 2-horse van and 2 men, \$1.50 per hr.; storage \$1 per mo. Satisfaction guar. D. 433 & Ty. 130.

FIDELITY RENTAL FREE
Flood Douglas 25 for complete list of vacant houses and apartments; also for storage, moving, 16th and Jackson Sts. RUCOM, 117 Leavenworth. Phone D. 302.

Gordon Van Co. Moving, Packing, Storage.
1500 N. 24th St. Tel. D. 24 or W. 181.

1500 N. 24th, 8 rooms and bath, \$15.
1007 Chicago, 8 rooms, modern, \$20.
2514 St. Mary's Ave., 8 rooms, \$20.
KINGWALT, 714 Brandeis Theater.
SEE THE Central Furniture Store. FREE RENTAL LIST.

ALL sizes, 12 per month up. 107 Paxton.

Maggard's Van and Storage Co. Call us for estimates for moving, packing, shipping. 1713 Webster St. Douglas 180.

J. C. Reed Exp. Co., moving, packing & storage.
1267 Farnam, D. 614.

Stores and Offices.
Nice Cool Office
With Vault
Near the Elevator and Stairs
Electric Light Free

THE BEE BUILDING COMPANY,
Superintendent's Office, Room 103.

FOR RENT—Ground floor and basement
Masonic brick building, 20x30 feet,
Kawneer front corner lot, business section,
country seat. Inquire of J. L. Grimm,
Wilber, Neb.

Office on 17th St.
Double Windows
ONLY VACANT ROOM
AVAILABLE ON THE
STREET.

Private office—Waiting Room
180 So. Ft.—\$18.50

The Bee Building
Office Room 103.

REAL ESTATE
FARM & RANCH LANDS FOR SALE

Colorado.
FOR SALE—Four sections Cheyenne
county, Colo., land for sale. Good col-
ony proposition. Address T. G. Bee.

REAL ESTATE

FARM & RANCH LANDS FOR SALE
California.
Live Oak Colony—home better. W. T.
Smith Co., 2124 City Nat. Bk. D. 2124.

Florida.
FORTY ACRES, two miles from Arcadia.
Fla., what have you to trade, worth
\$2,000. Box 211, Tecumseh, Neb.

Minnesota.
MINN. farms; low price, easy terms.
Minnesota Land Co., P. O. 21, Omaha.

40 ACRES 4 1/2 miles from Minneapolis.
One mile from town, 150 acres under
cultivation; balance used for pasture;
can practically all be cultivated; heavy
soil; good set buildings, consisting of 4-
room house, large barn, granary, corn
cribs, windmill, etc.; the land will pro-
duce 10 bushels of corn per acre; tele-
phone in house; country thickly settled;
complete set of machinery; 11 head of
stock, consisting of 12 cows, balance 1
and 2 years old; six good horses; 25 hogs;
chickens; one-half of this year's crop and
everything on farm goes at \$50 per acre;
half cash. Schwab Bros., 1023 Plymouth
Bldg., Minneapolis, Minn.

NEBRASKA.
BIG LAND BARGAIN.
Section smooth, rich land, northwest of
Dallin, Cheyenne county, Neb., only
\$15.00 an acre. Hicks Land Agency, Omaha.

W—For sale, dandy 410, improved
stock, Kimball Co., Neb., Douglas 110-0.
JIM WRAY, SIOUX CITY.

Well Improved Central
Nebraska Farm

This farm of 215 acres lies 2 miles from
the county seat in Garfield county. It
is well rented and every foot of it will raise
alfalfa. It can be bought for \$10 per
acre now and owner might take smaller
place in or around Omaha in exchange.

PAYNE INVESTMENT CO.,
5th Fl., New Omaha National Bank Bldg.—110-0

I HAVE 640 acres of land in Garfield
county, Neb. Would like to sell. Will
take \$1 per acre for it. Address W. T.
Keeva, Denton, Neb.

REAL ESTATE LOANS
FARM LOANS, 6 PER CENT.
TOLAND & TRUMBULL, 448 Bee Bldg.
\$100 to \$10,000 made promptly. F. D.
Weed, Weed Bldg., 15th and Farnam Sts.

CITY and farm loans, 5 1/2, 6 per cent.
J. H. Dumont & Co., 415 State Bank.

WANTED—City loans and warrants. W.
Farnam Smith & Co., 123 Farnam St.

WANTED—Good farm and city loans at
lowest rates.
PETERS TRUST CO., 123 Farnam.

CITY property. Large loans a specialty.
W. H. Thomas, 225 State Bank Bldg.

MONEY on hand for city and farm loans.
H. W. Binder, City National Bank Bldg.

REAL ESTATE—SUBURBAN

Dundee.

"DUNDEE"
"WEST FARNAM DISTRICT"

Big Sale of Dundee Lots

Saturday Beginning at 9 o'clock
Sale From 9 A. M. to 9 P. M.

HOW TO REACH THE SALE.

Take a Dundee car. GET OFF AT 49TH AND DODGE STREETS. Don't miss this sale.

We will sell your home. Why not move to the new district, where every-thing is being done to secure ideal home-like surroundings.

PRICES are low in this sightly tract of ground.

TERMS can be arranged to suit purchaser. No discount for cash. CALL DOUGLAS 2596, we will send a salesman with an automobile after you. Send for plat and price list.

H. H. HARPER & COMPANY
1013-14 City National Bank Building.

REAL ESTATE—SUBURBAN

Dundee.

"DUNDEE"
"WEST FARNAM DISTRICT"

Big Sale of Dundee Lots

Saturday Beginning at 9 o'clock
Sale From 9 A. M. to 9 P. M.

HOW TO REACH THE SALE.

Take a Dundee car. GET OFF AT 49TH AND DODGE STREETS. Don't miss this sale.

We will sell your home. Why not move to the new district, where every-thing is being done to secure ideal home-like surroundings.

PRICES are low in this sightly tract of ground.

TERMS can be arranged to suit purchaser. No discount for cash. CALL DOUGLAS 2596, we will send a salesman with an automobile after you. Send for plat and price list.

H. H. HARPER & COMPANY
1013-14 City National Bank Building.

REAL ESTATE—SUBURBAN

Dundee.

"DUNDEE"
"WEST FARNAM DISTRICT"

Big Sale of Dundee Lots

Saturday Beginning at 9 o'clock
Sale From 9 A. M. to 9 P. M.

HOW TO REACH THE SALE.

Take a Dundee car. GET OFF AT 49TH AND DODGE STREETS. Don't miss this sale.

We will sell your home. Why not move to the new district, where every-thing is being done to secure ideal home-like surroundings.

PRICES are low in this sightly tract of ground.

TERMS can be arranged to suit purchaser. No discount for cash. CALL DOUGLAS 2596, we will send a salesman with an automobile after you. Send for plat and price list.

H. H. HARPER & COMPANY
1013-14 City National Bank Building.

REAL ESTATE—MISCELLANEOUS

Dundee.

**Owner Wants to
Sell Beautiful
7-Room House**

This house is located 1/4 block from car line, in beautiful section of the city, where everything is modern and up-to-date, and where the surroundings are extremely pleasant. House is finished in oak in principal rooms and is well built and very conveniently arranged.

Will Take \$500 Cash As First Payment and Balance Can Be Arranged in Monthly Payments.

For further particulars telephone D. 2524 today. Call Wal. 922 after 7 o'clock tonight.

GOOD HOME—\$750.
Nice little 4-room cottage. Gas, city water and lot \$2500. Only \$150 cash; balance \$8 per month. Location 24th and D Sts., South Omaha.

ANOTHER ONE—NORTH SIDE.
Same price for a 3-room house and large full lot in Clairmont add. Close to car and school. The lots are worth between \$100 and \$200 in this addition. Don't you think you had better invest in a home even though it is a small one? It will be your own.

PAYNE INVESTMENT CO.,
5th Floor, Omaha Nat. Bank Bldg.
Phone Doug. 1181.

REAL ESTATE—INVESTMENTS
FOR SALE—or rent; truckage building, 11th and Seward, 32x28, Apply 1421 Gust St.

REAL ESTATE WANTED
FOR sales, rentals, loans, insurance, care of property and collection of rent see F. D. WELAD, 181 Farnam.

REAL ESTATE—VACANT
LOT 4x130, well improved walks; shade trees, etc. Price, \$200. Inquire 1200 Jaynes St., N. Omaha, Neb. 212.

Apartment, flats, houses and cottages can be rented quickly and cheaply by a

**Here is the
Opportunity You've
Been Watching for**
A Beautifully Located
6-Room, New, All
Modern Bungalow.

\$300 Cash—
Monthly Payments to Suit.
This house is only 1/4 block from car line; is on a beautiful lot; principal rooms in oak; brick fireplace, cement basement and all modern.

Phone Doug. 308 today and we'll be pleased to send an automobile to bring you out and inspect this house. This

LEGAL NOTICES

OFFICE OF COMMISSARY, FOURTH INFANTRY, U. S. ARMY.
Sealed proposals, in duplicate, for furnishing and delivering on or before August 1, 1915, at Fremont, Neb., subsistence stores as below, in accordance with specifications and conditions set forth in Circular No. 3, Office of the Commissary General, Washington, D. C., April 21, 1915, will be received at this office until ten o'clock A. M., August 3, 1915, and then opened. Specifications will be furnished upon request. Dell F. Lough, Captain Commissary, Fourth Infantry, U. S. A.

25 lbs. Beans, 20 lbs. Rice, 3,025 lbs. Potatoes, 1,050 lbs. Onions, 55 cans Tomatoes, 100 lbs. Prunes, 37 cans E. S. Jam, 25 lbs. Peaches (dried), 25 lbs. Coffee (roasted and ground), 500 lbs. Sugar, 125 cans Milk (family size), 75 gals. Vinegar, 10 gals. Sour Pickles, 100 lbs. Salt, 45 cans Pepper (black), 150 lbs. Lard, 66 lbs. Butter (creamery), 66 lbs. Oleomargarine, 42 gals. Syrup, 20 lbs. Laundry Soap, 20 bottles Vanilla Extract (3 oz.), also 1/2 lbs. Fresh Eggs, 94 lbs. Bacon, 450 lbs. Fresh Bread, 200 lbs. Flour, to be delivered as specified. Jy 28th.

**Charge Purchases
On the Accounts of
Prominent Omahans**

Mrs. Anna Taylor and daughter, Besse, were before Judge Britt charged with securing goods under false pretenses. They were accused of having charged goods at Brandeis on the accounts of Dr. Gifford and Gottlieb Store, at Courtney's on other accounts, at Burgess-Nash on the accounts of H. E. Bowen and F. W. Camp, and on still other accounts at Hayden's and Thompson-Belden.

Another group of goods secured amounted in value to about \$100. They were arrested in the Burgess-Nash store and had with them \$12.50 worth of goods. Some few purchases had been returned for cash credit, but only \$2.25 was secured in this manner. They were given ninety days each.

**JOHN D. CREIGHTON GIVES
TWO LOTS TO UNIVERSITY**

John D. Creighton has just deeded two lots as a gift to Creighton university. The two lots front on Cass street, and are just across the alley from St. John's parish school. The school children of the parish school have used the lots for some time as playgrounds. The lots are now to be specially developed for playground purposes.

**ASSAULTED BY NEGROES
IN UNDERWORLD SALOON**

Hans Meier was the victim of the combined assaults of three negroes in the Underworld saloon at 21st and Dawson street Thursday night, but did not know it until morning, when he awoke somewhere outside with a headache and an empty pocketbook. He was deeded out, but the thugs got only \$1.

LEGAL NOTICES
NOTICE TO CONTRACTORS.
Sealed proposals will be received at Lincoln, Nebraska, by the Board of Education, Nebraska State Normal Schools, up until ten o'clock a. m., August 3, 1915, for the erection of a brick and stone auditorium for the State Normal School at Kearney, Nebraska, in accordance with plans and specifications prepared by J. H. Craddock, Architect, Room 12, Continental Building, Omaha, Nebraska. The Board of Education, Nebraska State Normal Schools, will also receive proposals for the heating, plumbing and electric wiring for above building, according to plans and specifications prepared by the architect, up until the hour and date above named.

All bids must be accompanied by a certified check for five (5) per cent of the full amount of bid, made payable to U. S. Hall, State Treasurer of Nebraska. The Board reserves the right to accept any or reject any or all bids.

Signed by the President and the Secretary of the Board of Education, Nebraska.

REAL ESTATE—NORTH SIDE

REAL ESTATE—SOUTH SIDE

REAL ESTATE—WEST SIDE

REAL ESTATE—MISCELLANEOUS